

GENERAL SPECIFICATIONS

• L.O.A*:	13,43m	44'1"
• Hull length:	12,52m	41'1"
• Overall width:	4,25m	13'11"
• Beam:	4,20m	13'9"
• Light displacement:	10 520kg	23 186 lbs
• Air draft (max):	4,32m	14'2"
• Draught (including propeller):	1,15m	3'9"
• Fuel tank:	1 170L	309 US Gal
• Water tank:	400L	106 US Gal
• Sewage tank:	120L	32 US Gal
• Grey water tank (Option):	320L	66 US Gal
• Engine power:	2 x 270 HP	2 x 270 HP - 2 x 201 KW
	2 x 320 HP	2 x 320 HP - 2 x 238 KW

* with aft swimming platform + Anchor in position

ARCHITECTS / DESIGNERS

- Naval Architect: BENETEAU POWER
- Exterior and interior design: Andreani Design

EC CERTIFICATION

- Category B - 8 people
- Category C - 10 people
- Category D - 10 people

sean@apps

CONNECT YOUR BOAT FREE YOUR MIND



STANDARD EQUIPMENT

CONSTRUCTION

HULL

Composition:

- Sandwich (Polyester resin contact - Glass fiber - Balsa core)
- White gel coat (RAL 9010)
- Structural hull counter moulding in monolithic laminate (Polyester resin contact - Glass fiber)

Profile:

- Semi-floating hull

DECK

Composition:

- Sandwich (Polyester resin contact - Glass fiber / Balsa core)
- Structural counter moulding in monolithic laminate (Polyester resin - Glass fiber)
- White gel coat (RAL 9010)
- Diamond tip type non-slip covering

DECK EQUIPMENT

- Side gate opening to starboard
- Polyester mast for mounting navigation lights, radar and aerials
- Fog horn

MOORING LINES - MOORING

- 1 000 W Vertical electrical windlass, up / down and remote control from the windlass, wheelhouse and flybridge
- 10 Mooring cleats (L 300mm / 12")
- Stainless steel gunwale guards
- 1 Compartment fitted with self-bailers and polyester covers

SAFETY ON DECK

- Stainless steel pulpit, open and surrounding cockpit up to steps
- Leather covered stainless steel handrails in the cockpit

COCKPIT

- Self-bailing cockpit
- 1 Locker in cockpit bottom gas piston assisted and lockable
- Gas cylinder locker integrated into the cockpit aft bench
- Hot/cold water cockpit shower
- Double starboard access door to the cockpit
- Swimming platform with rubbing strake (3,80 x 1,15mm / 12'6" x 3'9")
- 1 Sliding bench seat on the platform
- 1 Ergonomic bathing ladder with hand holds in the bathing platform
- 1 Emergency ladder
- 1 PMMA access door at the starboard side deck from the cockpit



INTERIOR

- Choice of woodwork: Alpi teak (standard) or Alpi oak strip (optional)
- Rovere Alévé type laminated floorboards
- Interior upholstery Marlin Brilliant white PVC
- PVC pilot bench Marlin white & Polaris
- Exterior upholstery Marlin Brilliant white PVC

INTERIOR STEERING STATION

- Grey helm console
- Clear glass windscreen with aluminum frames, black lacquered
- Anti-reflective coating
- 3 Electric windscreen wipers with synchronizing system
- Windscreen washer
- Defogger
- Side windows with black lacquered aluminum frames
- Dashboard with place for navigation electronics
- Engine dials: Revolution counter, Fuel gauge, Warnings, Rudder angle indicator, Flap indicators
- Controls: Electric windlass, Bow thruster, Navigation lights, Electric windscreen wipers, Fog horn & Electric dual engine controls
- Steering wheel
- Steering compass
- Double USB socket
- Dual pilot bench seat with hand rails
- Removable floor step
- Sliding side door with direct access to catwalk
- Cup holder

SALOON

- Headroom: 1,90m / 6'33"
- U-shaped saloon convertible to double berth
 - Dividing rail and curtains for berth
 - Roman blinds
 - Varnished wood saloon table
 - Storage cupboards
 - 1 Large stowage drawer
 - Sliding aft 2 single disappearing door aft bay with black lacquered aluminum frame
 - Leather sheathed stainless steel handrail in cockpit deckhead
 - Fusion RA210 player with 2 speakers in the wheelhouse and 2 speakers in the cockpit

GALLEY

- Headroom: 1,95m / 6'5"
- U-shaped galley, facing the cockpit and the saloon - Includes:
- Corian Nimbus Prima countertop
 - 2 Stainless steel sinks with cold/hot water mixer taps under pressure
 - Gas oven
 - 3-burner gas hob with protective glass cover
 - 215 L upright fridge with freezer function
 - Storage & Drawers
 - Bin with access from cockpit and galley
 - Handrails

OWNER'S CABIN (FORWARD)

- Headroom: 1,95m / 6'5"
- Double berth (1,95 x 1,60m / 6'5" x 5'3")
 - Storage under berth
 - Stowage on both sides of berth
 - Mirror
 - 1 Hanging locker with lighting
 - 1 Cupboard with shelves
 - 1 Opening deck hatch with fitted mosquito screen/blind
 - 2 Hull windows with opening portholes and blackout blind
 - Venetian blinds
 - Padded headboard

HEAD (OWNER'S CABIN)

- Headroom: 1,95m / 6'5"
- Separate shower compartment with seat and porthole and solid wood finish
- Mirror
 - Top and bottom cupboard
 - Electric toilet flushing with fresh water and salt water
 - Oval washbasin
 - 1 Opening deck hatch with integrated blind
 - 1 Hull porthole
 - Venetian blinds

VIP CABIN (PORT)

- Headroom: 1,96m / 6'6"
- 2 Single beds convertible into double beds (1,96 x 1,52m / 6'5" x 5'8")
 - Cupboards
 - Storage under berth
 - Cubby hole locker
 - Hull window with opening porthole and blackout blind
 - 1 220 V socket
 - 2 USB sockets
 - Padded headboard

LAZARETTE / THIRD CABIN (STARBOARD)

- Headroom: 2,10m / 6'11"
- Modular stowage
 - Storage under berth
 - Space for washer dryer
 - 1 220 V socket
 - 2 USB sockets

STARBOARD HEADROOM (DAY TOILET)

- Headroom: 1,92m / 6'4"
- Mirror
 - Top and bottom cupboard
 - 1 Opening porthole
 - Electric toilet flushing with fresh water and salt water
 - Oval washbasin
 - Mixer tap
 - Shower
 - Towel rail



ENGINE

- Yanmar 8LV 320 HP Diesel
- Shaft line propulsion
- Four-blade propellers
- Fuel filters
- Sea water filters
- Engine room soundproofed with high density foam (40 mm / 1-½" thick)
- Air intake for cooling the engine compartment on the port hull plating
- 1 Extinguisher
- Dual deck filler for fuel tank with interconnection
- 2 Aluminum fuel tanks (capacity = 2 x 585 L/2 x 155 US Gal) with interconnection and provision for attachment of FPS (Fuel Polishing System) system
- Steering system:
 - 2 Underhung rudders stainless steel
 - Hydraulic steering
 - Electric trim tabss

ELECTRICITY

- Electrical panel (12V / 220V)
- Shore power socket (220V)
- 10 220V Sockets:
 - 2 in the saloon
 - 2 in galley
 - 2 in owner cabin
 - 1 in the VIP cabin
 - 1 in the 3rd cabin
 - 1 in the owner head
 - 1 in the 2nd head
- 12 USB sockets:
 - 2 in the saloon
 - 2 at the pilot station
 - 4 in owner cabin
 - 2 in the VIP cabin
 - 2 in the 3rd cabin
- 4 Engine batteries (12V - 50Ah)
- 2 Service battery (12V - 140Ah)
- 2 Battery chargers (25Ah)
- Outside and inside lighting (Overhead lights, Reading lights)
- LED indirect lighting
- Outside lighting (Navigation lights, Anchor light with stainless steel mountings)

PLUMBING

- 1 Manual bilge pump (Cockpit)
- 2 Automatic electric bilge pumps
- Water unit for pressurizing the hot / cold water circuit with accumulator tank
- 40 L / 11 US Gal water heater working off engine exchanger and 220 V
- Water tank filler
- 2 Roto moulded water tanks (2 x 200L / 2 x 53 US Gal)
- Drainage outlet for black water holding tank
- 1 Sewage tank (120L / 32 US Gal)
- 1 Waste water tank (45L / 12 US Gal)

SMART BOARD

"SEANAPPS" smart technology:

- For monitoring the boat's status and receiving alerts as well as maintenance advice via the associated mobile application.
- The type of information collected (GPS position, batteries, engine info, navigation data, etc.) varies according to the boat's configuration.

seanapps

CONNECT YOUR BOAT FREE YOUR MIND

MISCELLANEOUS ITEMS

- Smoke detector



TRIM LEVEL & PACKS

TRIM LEVEL

	ESSENTIAL	CONFORT
<ul style="list-style-type: none"> • Pump for deck washing • 12V Cockpit socket • Pre-wiring for heating • Air conditioning pre-arrangement • 1 9" Raymarine interior screen • Raymarine VHF • Cup holders 	<ul style="list-style-type: none"> • ■ • ■ • ■ • ■ • ■ • ■ • ■ 	<ul style="list-style-type: none"> • ■ • ■ • ■ • ■ • ■ • ■ • ■
<ul style="list-style-type: none"> • Shore fresh water supply • Deck searchlight • Inverter (2 KVA) 		<ul style="list-style-type: none"> • ■ • ■ • ■

PACKS

ELECTRONIC PACK

- Ship control
- Windvane anemometer
- Autopilot

AIR CONDITIONING PACK

- 7,5 kVA Generator (220V / 50Hz)
- Air conditioning (48 kBTU)

OPTIONS

AMBIANCE

- Oak strip version & Brown oak laminated floors
- Louvre doors, oak strip or teak
- Ivory varnished, oak strip or teak louvre doors
- African Spirit Grey carpet (Wheelhouse + Saloon)
- Skye 53 carpet (Cabins + Passageway)
- Infinity Zah Factor cream carpet (Cockpit)
- Greige fabric interior upholstery
- Crevin Noah 52 fabric interior upholstery
- VERTICE River Rock interior upholstery
- VERTICE Bianco interior upholstery
- VERTICE Cava interior upholstery
- VERTICE Robusta interior upholstery
- Confort - Dolce 51 outside upholstery
- Marlin Brilliant white PVC fore sun deck
- Confort - Dolce 51 forward sun deck
- Signal Grey hull (RAL 7004)



OTHER OPTIONS

INTERIOR ACCOMMODATION

- Rotating pilot seat with handrails + Saloon table extension
- Grill & Microwave combined oven (as replacement for gas oven)
- Washer dryer
- Dishwasher for 6 sets
- 3 burner induction hob (replacing gas stove)
- Ice maker
- Electric roof opening (only Sedan version)
- Forced air heating
- Single mattress in the 3rd cabin
- Mosquito screens on side door, aft bay and portholes
- TV pre-wiring (Fusion Apollo 670 + Loud speakers) in the saloon
- TV pre-wiring (Fusion Apollo 670 + Loud speakers) in the forward cabin
- Tableware kit - 6 people

EXTERIOR OPTIONS

- Mooring kit:
 - Delta anchor 20 kg/35 lbs
 - Chain (10mm diameter - length 32 m)
 - Line (18mm diameter - length 45 m)
 - 4 Mooring ropes (18mm diameter - length 15 m)
 - 6 Fenders (250mm diameter - length 0,7 m)
- Stainless steel bow fitting
- Fore canvas sunshade
- Outside protections: (Oyster or Flanelle)
 - Aft cockpit closing
 - Cockpit wheelhouse cover
- Black exterior curtains Sunworker
- Manual fold-up polyester gangway
- Folding cockpit table + 2 Folding arm chairs
- Storage rack for paddle, bike with access ladder (Sedan version only)
- 5 Solar panels on the coachroof (Sedan version only)
- Tender launching system on Plastimo davits (Tender: maximum length 2,6 m, maximum weight 150 kg)

ELECTRICAL SYSTEM

- 7,5 kVA Generator
- Underwater light

WATER SYSTEM

- Watermaker (60 l/h / 16 US Gal/hour)
- Shore fresh water supply
- Rigid sewage reserve

ENGINE

- Bow thruster
- stern thruster

NAVIGATION ELECTRONICS

- Raymarine AIS
- Radar
- Rear camera

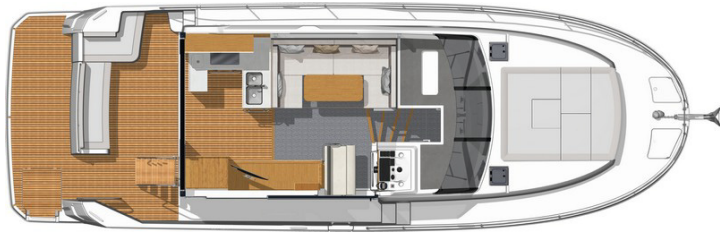
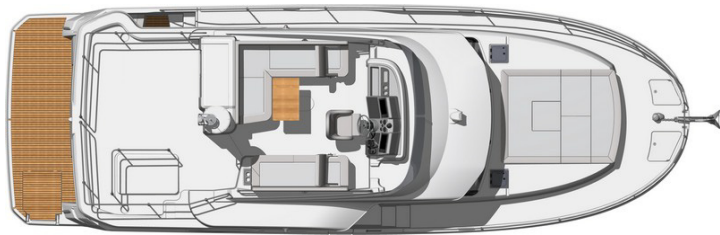

GENERAL SPECIFICATIONS

• L.O.A*:	13,43m	44'1"
• Hull length:	12,52m	41'1"
• Overall width:	4,25m	13'11"
• Beam:	4,20m	13'9"
• Light displacement:	11 040kg	24 332 lbs
• Air draft (max):	5,81m	19'1"
• Draught (including propeller):	1,15m	3'9"
• Fuel tank:	1 170L	309 US Gal
• Water tank:	400L	106 US Gal
• Sewage tank:	120L	32 US Gal
• Grey water tank (Option):	320L	66 US Gal
• Engine power:	2 x 270 HP	2 x 270 HP - 2 x 201 KW
	2 x 320 HP	2 x 320 HP - 2 x 238 KW

* with aft swimming platform + Anchor in position

ARCHITECTS / DESIGNERS

- Naval Architect: BENETEAU POWER
- Exterior and interior design: Andreani Design

EC CERTIFICATION

- Category B - 8 people
- Category C - 10 people
- Category D - 10 people

sean@apps

CONNECT YOUR BOAT FREE YOUR MIND



STANDARD EQUIPMENT

CONSTRUCTION

HULL

Composition:

- Sandwich (Polyester resin contact - Glass fiber - Balsa core)
- White gel coat (RAL 9010)
- Structural hull counter moulding in monolithic laminate (Polyester resin contact - Glass fiber)

Profile:

- Semi-floating hull

DECK

Composition:

- Sandwich (Polyester resin contact - Glass fiber / Balsa core)
- Structural counter moulding in monolithic laminate (Polyester resin - Glass fiber)
- White gel coat (RAL 9010)
- Diamond tip type non-slip covering

DECK EQUIPMENT

- Side gate opening to starboard

MOORING LINES - MOORING

- 1 000 W Vertical electrical windlass, up / down and remote control from the windlass, wheelhouse and flybridge
- 10 Mooring cleats (L 300mm / 12")
- Stainless steel gunwale guards
- 1 Compartment fitted with self-bailers and polyester covers

SAFETY ON DECK

- Stainless steel pulpit, open and surrounding cockpit up to steps
- Leather covered stainless steel handrails in the cockpit

COCKPIT

- Self-bailing cockpit
- 1 Locker in cockpit bottom gas piston assisted and lockable
- Gas cylinder locker integrated into the cockpit aft bench
- Hot/cold water cockpit shower
- Double starboard access door to the cockpit
- Swimming platform with rubbing strake (3,80 x 1,15mm / 12'6" x 3'9")
- 1 Sliding bench seat on the platform
- 1 Ergonomic bathing ladder with hand holds in the bathing platform
- 1 Emergency ladder
- 1 PMMA access door at the starboard side deck from the cockpit

FLYBRIDGE

- Flybridge self-draining
- Retractable stainless steel ladder with double access ramp to the flybridge with solid wood treads
- Grey tinted windscreen in PMMA
- Access by polyester hatch
- Stainless steel pulpit surrounding aft of flybridge
- Polyester mast for mounting navigation lights, radar and aerials
- Central steering console
- Control panel including: Electric engine controls, Electric windlass control, Thruster and Flaps
- Rev counter
- Rudder angle indicator
- Space for navigation electronics
- Steering wheel stainless steel
- Steering compass
- Hydraulic steering
- Fog horn
- Double USB socket
- 1 Adjustable pilot seat and 2 places for co-pilot with convertible backrest
- Flybridge face-to-face saloon with a bench seat in an L shape, with integrated stowage and a solid wood table
- GRP unit with sink, handrail and stowage
- Loud speakers



INTERIOR

- Choice of woodwork: Alpi teak (standard) or Alpi oak strip (optional)
- Rovere Alévé type laminated floorboards
- Interior upholstery Marlin Brilliant white PVC
- PVC pilot bench Marlin white & Polaris
- Exterior upholstery Marlin Brilliant white PVC

INTERIOR STEERING STATION

- Grey helm console
- Clear glass windscreen with aluminum frames, black lacquered
- Anti-reflective coating
- 3 Electric windscreen wipers with synchronizing system
- Windscreen washer
- Defogger
- Side windows with black lacquered aluminum frames
- Dashboard with place for navigation electronics
- Engine dials: Revolution counter, Fuel gauge, Warnings, Rudder angle indicator, Flap indicators
- Controls: Electric windlass, Bow thruster, Navigation lights, Electric windscreen wipers, Fog horn & Electric dual engine controls
- Steering wheel
- Steering compass
- Double USB socket
- Dual pilot bench seat with hand rails
- Removable floor step
- Sliding side door with direct access to catwalk
- Cup holder

SALOON

- Headroom: 1,90m / 6'33"
- U-shaped saloon convertible to double berth
 - Dividing rail and curtains for berth
 - Roman blinds
 - Varnished wood saloon table
 - Storage cupboards
 - 1 Large stowage drawer
 - Sliding aft 2 single disappearing door aft bay with black lacquered aluminum frame
 - Leather sheathed stainless steel handrail in cockpit deckhead
 - Fusion RA210 player with 2 speakers in the wheelhouse and 2 speakers in the cockpit

GALLEY

- Headroom: 1,95m / 6'5"
- U-shaped galley, facing the cockpit and the saloon - Includes:
- Corian Nimbus Prima countertop
 - 2 Stainless steel sinks with cold/hot water mixer taps under pressure
 - Gas oven
 - 3-burner gas hob with protective glass cover
 - 215 L upright fridge with freezer function
 - Storage & Drawers
 - Bin with access from cockpit and galley
 - Handrails

OWNER'S CABIN (FORWARD)

- Headroom: 1,95m / 6'5"
- Double berth (1,95 x 1,60m / 6'5" x 5'3")
 - Storage under berth
 - Stowage on both sides of berth
 - Mirror
 - 1 Hanging locker with lighting
 - 1 Cupboard with shelves
 - 1 Opening deck hatch with fitted mosquito screen/blind
 - 2 Hull windows with opening portholes and blackout blind
 - Venetian blinds
 - Padded headboard

HEAD (OWNER'S CABIN)

- Headroom: 1,95m / 6'5"
- Separate shower compartment with seat and porthole and solid wood finish
- Mirror
 - Top and bottom cupboard
 - Electric toilet flushing with fresh water and salt water
 - Oval washbasin
 - 1 Opening deck hatch with integrated blind
 - 1 Hull porthole
 - Venetian blinds

VIP CABIN (PORT)

- Headroom: 1,96m / 6'6"
- 2 Single beds convertible into double beds (1,96 x 1,52m / 6'5" x 5'8")
 - Cupboards
 - Storage under berth
 - Cubby hole locker
 - Hull window with opening porthole and blackout blind
 - 1 220 V socket
 - 2 USB sockets
 - Padded headboard

LAZARETTE / THIRD CABIN (STARBOARD)

- Headroom: 2,10m / 6'11"
- Modular stowage
 - Storage under berth
 - Space for washer dryer
 - 1 220 V socket
 - 2 USB sockets

STARBOARD HEADROOM (DAY TOILET)

- Headroom: 1,92m / 6'4"
- Mirror
 - Top and bottom cupboard
 - 1 Opening porthole
 - Electric toilet flushing with fresh water and salt water
 - Oval washbasin
 - Mixer tap
 - Shower
 - Towel rail



ENGINE

- Yanmar 8LV 320 HP Diesel
- Shaft line propulsion
- Four-blade propellers
- Fuel filters
- Sea water filters
- Engine room soundproofed with high density foam (40 mm / 1-1/2" thick)
- Air intake for cooling the engine compartment on the port hull plating
- 1 Extinguisher
- Dual deck filler for fuel tank with interconnection
- 2 Aluminum fuel tanks (capacity = 2 x 585 L/2 x 155 US Gal) with interconnection and provision for attachment of FPS (Fuel Polishing System) system
- Steering system:
 - 2 Underhung rudders stainless steel
 - Hydraulic steering
 - Electric trim tabs

PLUMBING

- 1 Manual bilge pump (Cockpit)
- 2 Automatic electric bilge pumps
- Water unit for pressurizing the hot / cold water circuit with accumulator tank
- 40 L / 11 US Gal water heater working off engine exchanger and 220 V
- Water tank filler
- 2 Roto moulded water tanks (2 x 200L / 2 x 53 US Gal)
- Drainage outlet for black water holding tank
- 1 Sewage tank (120L / 32 US Gal)
- 1 Waste water tank (45L / 12 US Gal)

ELECTRICITY

- Electrical panel (12V / 220V)
- Shore power socket (220V)
- 11 220V Sockets:
 - 2 in the saloon
 - 2 in galley
 - 2 in owner cabin
 - 1 in the VIP cabin
 - 1 in the 3rd cabin
 - 1 in the owner head
 - 1 in the 2nd head
 - 1 in the flybridge
- 14 USB sockets:
 - 2 in the saloon
 - 2 at the pilot station
 - 4 in owner cabin
 - 2 in the VIP cabin
 - 2 in the 3rd cabin
 - 2 on flybridge
- 4 Engine batteries (12V - 50Ah)
- 2 Service battery (12V - 140Ah)
- 2 Battery chargers (25Ah)
- Outside and inside lighting (Overhead lights, Reading lights)
- LED indirect lighting
- Outside lighting (Navigation lights, Anchor light with stainless steel mountings)

SMART BOARD

"SEANAPPS" smart technology:

- For monitoring the boat's status and receiving alerts as well as maintenance advice via the associated mobile application.
- The type of information collected (GPS position, batteries, engine info, navigation data, etc.) varies according to the boat's configuration.

sea@apps

CONNECT YOUR BOAT FREE YOUR MIND

MISCELLANEOUS ITEMS

- Smoke detector



TRIM LEVEL & PACKS

TRIM LEVEL

	ESSENTIAL	CONFORT
<ul style="list-style-type: none"> • Pump for deck washing • 12V Cockpit socket • Pre-wiring for heating • Air conditioning pre-arrangement • 1 9" Raymarine interior screen • 1 9" Raymarine exterior display • Raymarine dual station VHF • Cup holders 	<ul style="list-style-type: none"> • ■ • ■ • ■ • ■ • ■ • ■ • ■ • ■ 	<ul style="list-style-type: none"> • ■ • ■ • ■ • ■ • ■ • ■ • ■ • ■
<ul style="list-style-type: none"> • Shore fresh water supply • Double station deck searchlight • 40L refrigerator, in flybridge • Inverter (2 KVA) 		<ul style="list-style-type: none"> • ■ • ■ • ■ • ■

PACKS

ELECTRONIC PACK

- Ship control
- 1 9" Raymarine exterior display
- Windvane anemometer
- Autopilot (2 Posts)

ELECTRONIC PACK UPGRADED

- Ship control
- 1 12" Raymarine screen in wheelhouse
- 2 12" Raymarine screens on flybridge
- Windvane anemometer
- Autopilot (2 Posts)

AIR CONDITIONING PACK

- 7,5 kVA Generator (220V / 50Hz)
- Air conditioning (48 kBTU)

OPTIONS

AMBIANCE

- Oak strip version & Brown oak laminated floors
- Louvre doors, oak strip or teak
- Ivory varnished, oak strip or teak louvre doors
- African Spirit Grey carpet (Wheelhouse + Saloon)
- Skye 53 carpet (Cabins + Passageway)
- Infinity Zah Factor cream carpet (Cockpit)
- Greige fabric interior upholstery
- Crevin Noah 52 fabric interior upholstery
- VERTICE River Rock interior upholstery
- VERTICE Bianco interior upholstery
- VERTICE Cava interior upholstery
- VERTICE Robusta interior upholstery
- Confort - Dolce 51 external upholstery, with bolster seat on flybridge
- Marlin Brilliant white PVC fore sun deck
- Confort - Dolce 51 forward sun deck
- Signal Grey hull (RAL 7004)



BENETEAU

Swift Trawler 41 Fly

General Equipment list - Europe

OTHER OPTIONS

INTERIOR ACCOMMODATION

- Rotating pilot seat with handrails + Saloon table extension
- Grill & Microwave combined oven (as replacement for gas oven)
- Washer dryer
- Dishwasher for 6 sets
- 3 burner induction hob (replacing gas stove)
- Ice maker
- Forced air heating
- Single mattress in the 3rd cabin
- Mosquito screens on side door, aft bay and portholes
- TV pre-wiring (Fusion Apollo 670 + Loud speakers) in the saloon
- TV pre-wiring (Fusion Apollo 670 + Loud speakers) in the forward cabin
- Tableware kit - 6 people

EXTERIOR OPTIONS

- Mooring kit:
 - Delta anchor 20 kg/35 lbs
 - Chain (10mm diameter - length 32 m)
 - Line (18mm diameter - length 45 m)
 - 4 Mooring ropes (18mm diameter - length 15 m)
 - 6 Fenders (250mm diameter - length 0,7 m)
- Stainless steel bow fitting
- Fore canvas sunshade
- Set of flybridge covers (console + Bench seat + Table)
- Outside protections: (Oyster or Flanelle)
 - Aft cockpit closing
 - Cockpit wheelhouse cover
 - Flybridge bimini top
- Black exterior curtains Sunworker
- Manual fold-up polyester gangway
- Electric flybridge grill
- Folding cockpit table + 2 Folding arm chairs
- Flip-top flybridge table
- 3 Solar panels on flybridge pushpit
- Tender launching system on Plastimo davits (Tender: maximum length 2,6 m, maximum weight 150 kg)

ELECTRICAL SYSTEM

- 7,5 kVA Generator
- Deck searchlight
- Underwater light

WATER SYSTEM

- Watermaker (60 l/h / 16 US Gal/hour)
- Shore fresh water supply
- Rigid sewage reserve

ENGINE

- Bow thruster
- stern thruster

NAVIGATION ELECTRONICS

- Raymarine AIS
- Radar
- Rear camera