

M7

THE SOUND OF SERENITY



PRESTIGE®

MAIN CHARACTERISTICS

Length over all	17,84 m	58' 6"
Hull length	17,7 m	58' 1"
Hull beam	7,56 m	24' 9"
Water draft without hardtop (full load)	1,55 m	5' 1"
Air draft without hardtop (light)	5,45 m	17' 1"
Air draft with hardtop (light)	8,14 m	26' 8"
Light displacement	35 937 kg	79 227 Lbs
Full load displacement	45 902 kg	101 197 Lbs
Berths	8 + 2 skipper std + 1 option	
Cabins	4 + 1 skipper std + 1 option	
Bathrooms	4	
CE Certification	A12 – B14 – C16 – D20	

Architects **Garroni Design | Marc Lombard Yacht Design**

CAPACITIES

Fuel capacity	2 900 L	768 US gal
Water capacity	760 L	200 US gal
Hot water heater capacity	2 x 60 L	2 x 16 US gal
Grey water capacity	2 x 100 L	2 x 26 US gal
Black water capacity	340 L	90 US gal

ENGINE – PERFORMANCES

Engine power	VOLVO D8 V-DRIVE 2 x 550 CV/HP	
	Preliminary estimation	
Max. speed	22 knots*	
Cruising speed	17 knots*	
Range at 17 kn	632 nm*	

* Performance depends on sea conditions, water and air temperature, propeller cleanliness and yacht load. This data indicates the speed at an average load of the STD yacht with hardtop.

SILENT MODE PACKAGE

- Solar panels on flybridge, hardtop and deck (16 m² / 215ft² – 2,6Kw)
- Lithium battery pack (x10)
- Water heater: 2 x 80L / 2 x 21 US gal instead of 2 x 60L / 2 x 15 US gal
- Inverter 24V / 230V / 5Kw
- Upgrade generator 27KVA

LONG RANGE PACKAGE

- Bigger Fuel tanks up to 3 400 L / 900 US gal
- Bigger Grey tanks up to 340 L / 90 US gal
- Dual fuel/water separator with alarm

A sleek, modern white yacht with a dark blue stripe and a large upper deck with a canopy, sailing on the ocean at sunset. The yacht is viewed from a side-rear perspective.

➤➤ MORE SUSTAINABLE

NO DIRECT CO2 EMISSIONS,
A MINIMAL CARBON FOOTPRINT,
A MINIMAL OCEAN IMPACT.

➤➤ AUTONOMY

10 HOURS AT NIGHT
OR 2 HOURS DURING THE DAY.

➤➤ SILENCE & COMFORT

NO GENERATOR, NO VIBRATION,
NO NOISE POLLUTION.

PRELIMINARY DATA, NOT DEFINITIVE.

M7

FULL OPTION PROFILE



- ✦ Elegant lines
- ✦ 200 m² living space
- ✦ Thin silhouette thanks to balanced proportions (H-TOP option)

* PRELIMINARY DATA, NOT DEFINITIVE.

M7 STANDARD PROFILE



- Elegant lines
- 200 m² living space
- Thin silhouette thanks to balanced proportions

* PRELIMINARY DATA, NOT DEFINITIVE.

✦ Flat floor design and no structural constraints to maintain flexibility in all the spaces and solutions.

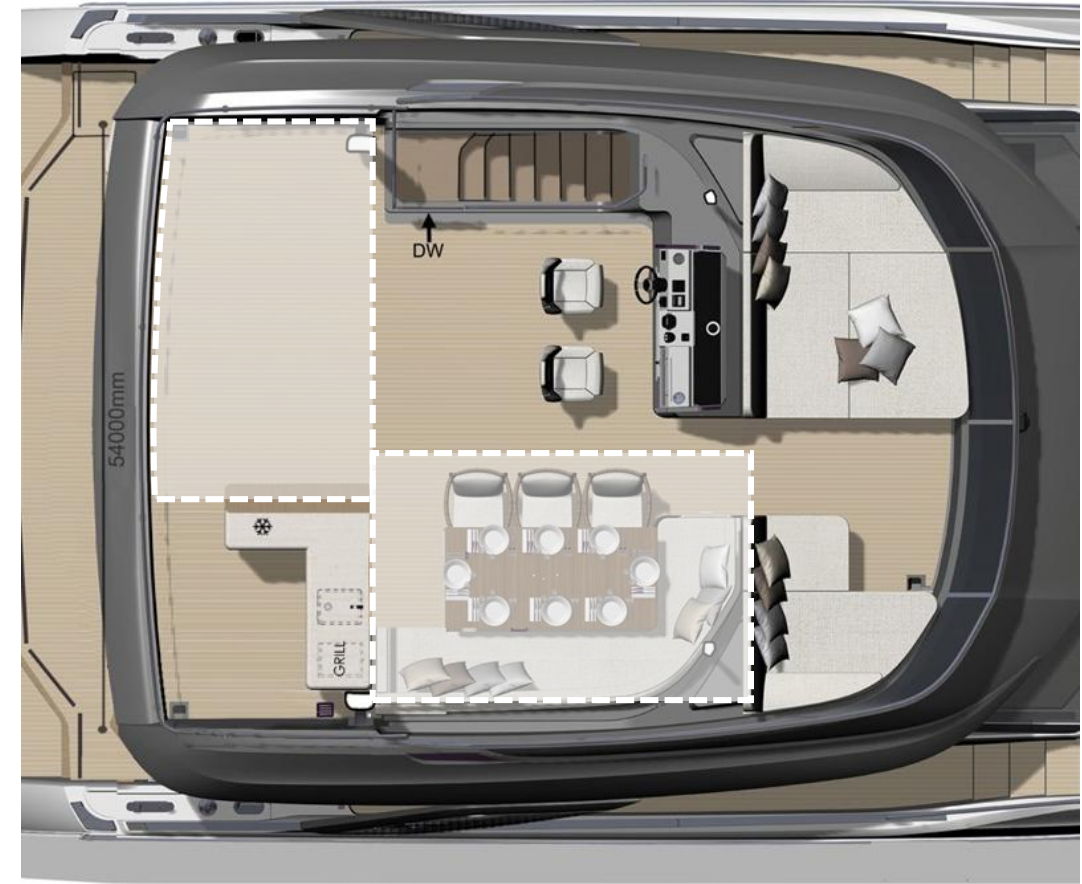
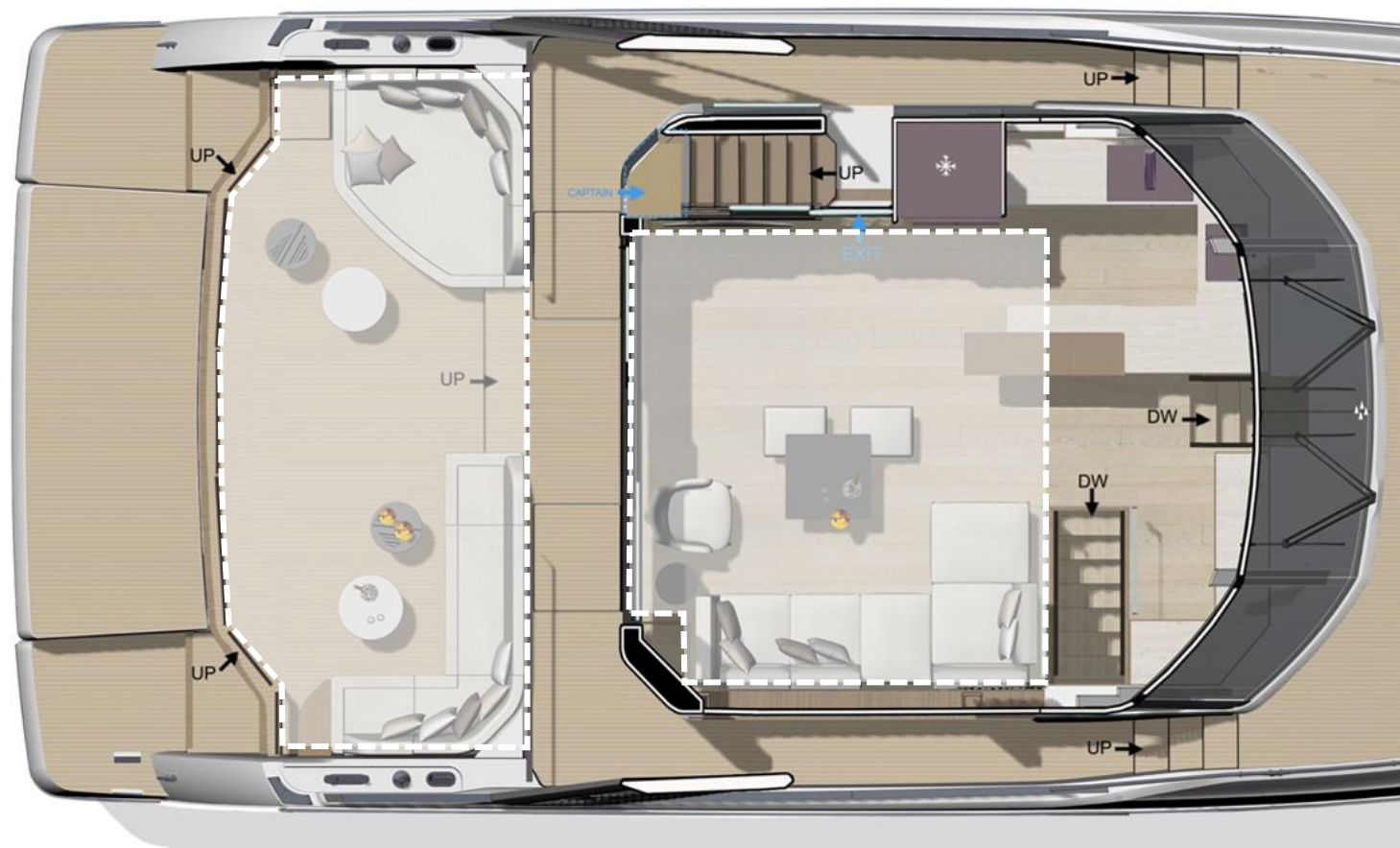

* PRELIMINARY DATA, NOT DEFINITIVE.

Weaving effect



Mesh and glass
Subtile transparency



Bronze metallic frame



Soft touches

Reassuring atmosphere

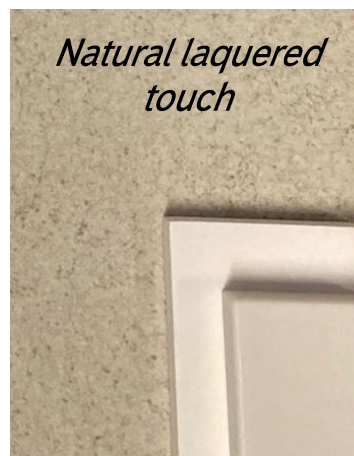

Warm decorative pillow

Elegant colours

Whispered luxury with soft colour combinations

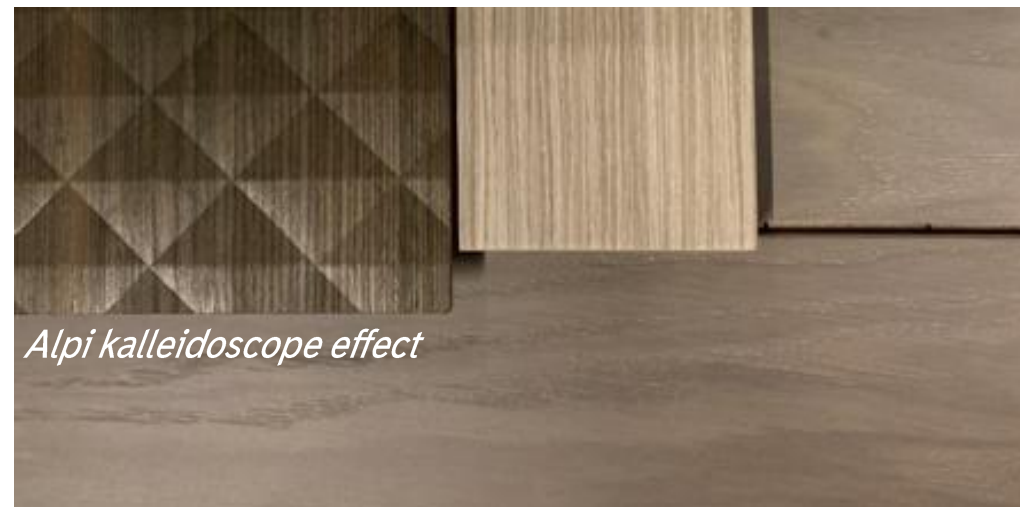

Alpi kalleidoscope effect

* PRELIMINARY DATA, NOT DEFINITIVE.

M7 FLEXIBLE FLYBRIDGE



- 35 m² (377ft²) living space
- Enclosed and protected Skylounge in option
- Personal touch zone (loose furniture)

* PRELIMINARY DATA, NOT DEFINITIVE.

M7 FLEXIBLE FLYBRIDGE

Optional loose furniture

Optional Hardtop with opening roof

Forward facing sun and living area

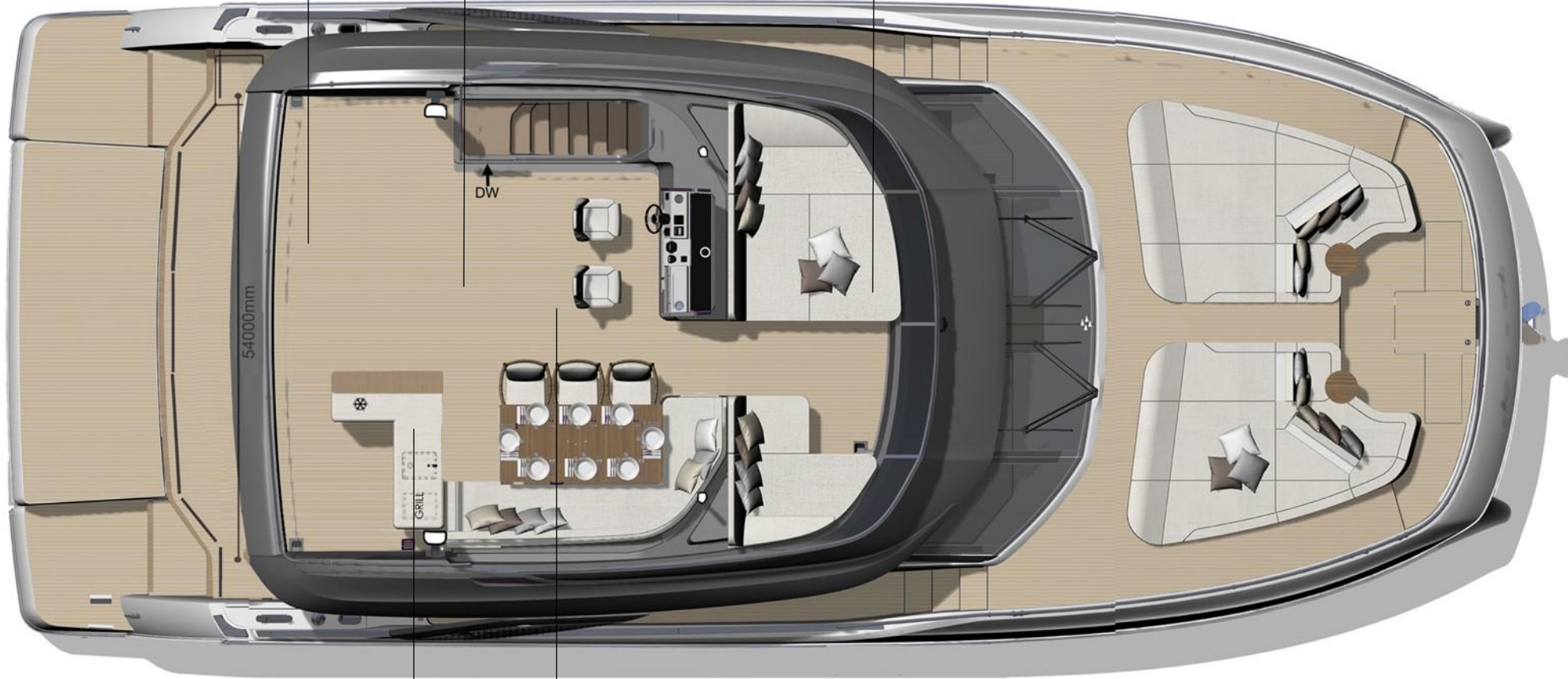

fully equipped Galley

Skylounge option for a protected flybridge

35 m² (377ft²) living space

* PRELIMINARY DATA, NOT DEFINITIVE.

M7

COCKPIT OF INFINITE POSSIBILITIES



- Pool Terrace Full-Beam living
- Large multiposition hydraulic bathing platform

* PRELIMINARY DATA, NOT DEFINITIVE.

M7

COCKPIT OF INFINITE POSSIBILITIES



- Pool Terrace Central U-shape living
- Large multiposition hydraulic bathing platform

* PRELIMINARY DATA, NOT DEFINITIVE.



- Space bathed in natural light
- Flexible lounge to suit your needs

* PRELIMINARY DATA, NOT DEFINITIVE.



- ❖ Space bathed in natural light
- ❖ Flexible lounge to suit your needs

* PRELIMINARY DATA, NOT DEFINITIVE.

M7
LIVING ROOM LIKE HOME



* PRELIMINARY DATA, NOT DEFINITIVE

M7

LIVING ROOM LIKE HOME



* PRELIMINARY DATA, NOT DEFINITIVE.

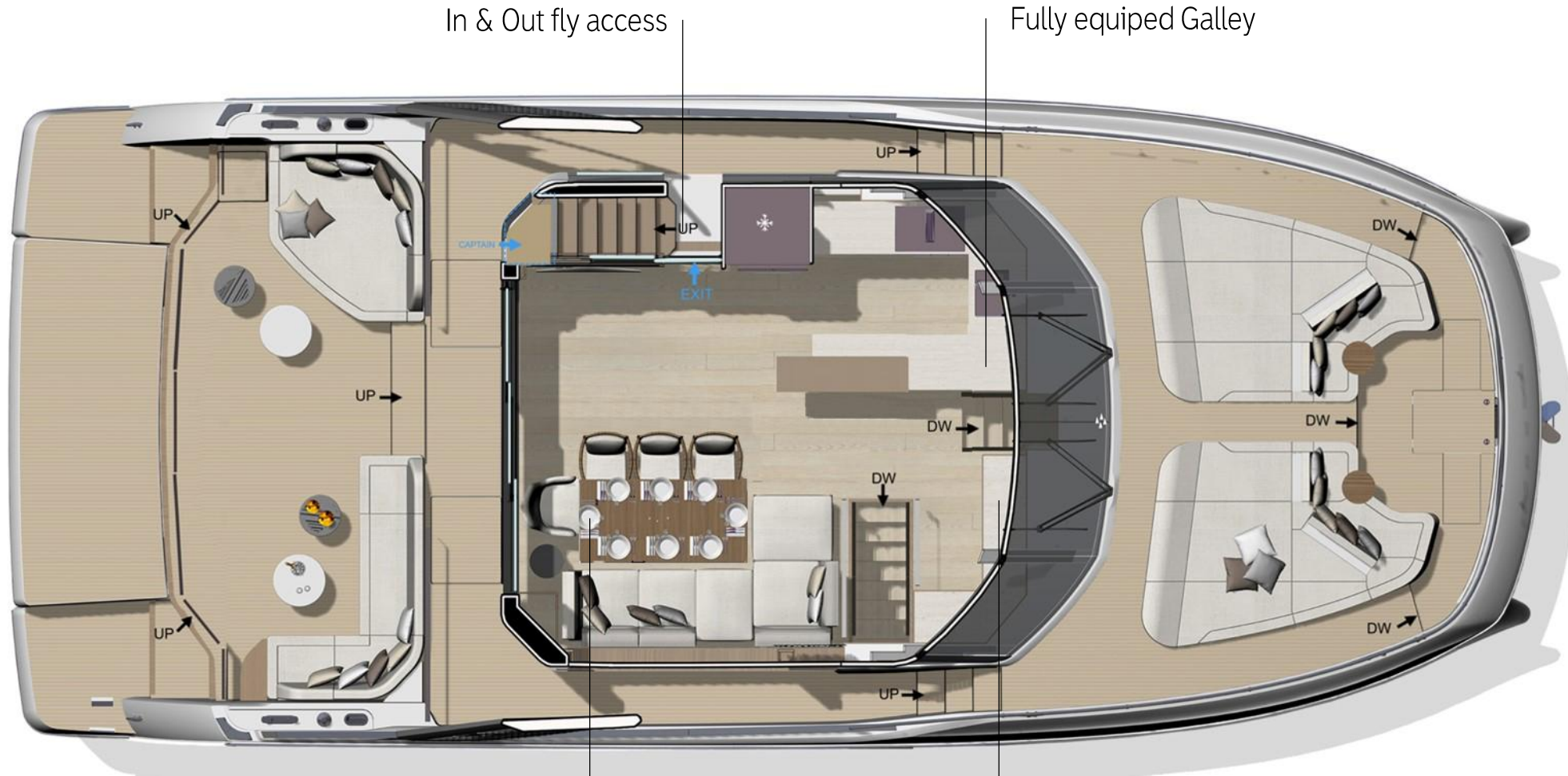

In & Out fly access

Fully equipped Galley

Private internal dining table

Optional interior helm station

112 m² (1206ft²) living space

* PRELIMINARY DATA, NOT DEFINITIVE.

Pool Terrace Full-Beam living + dining table

In&Out fly access

Private Bow Lounge

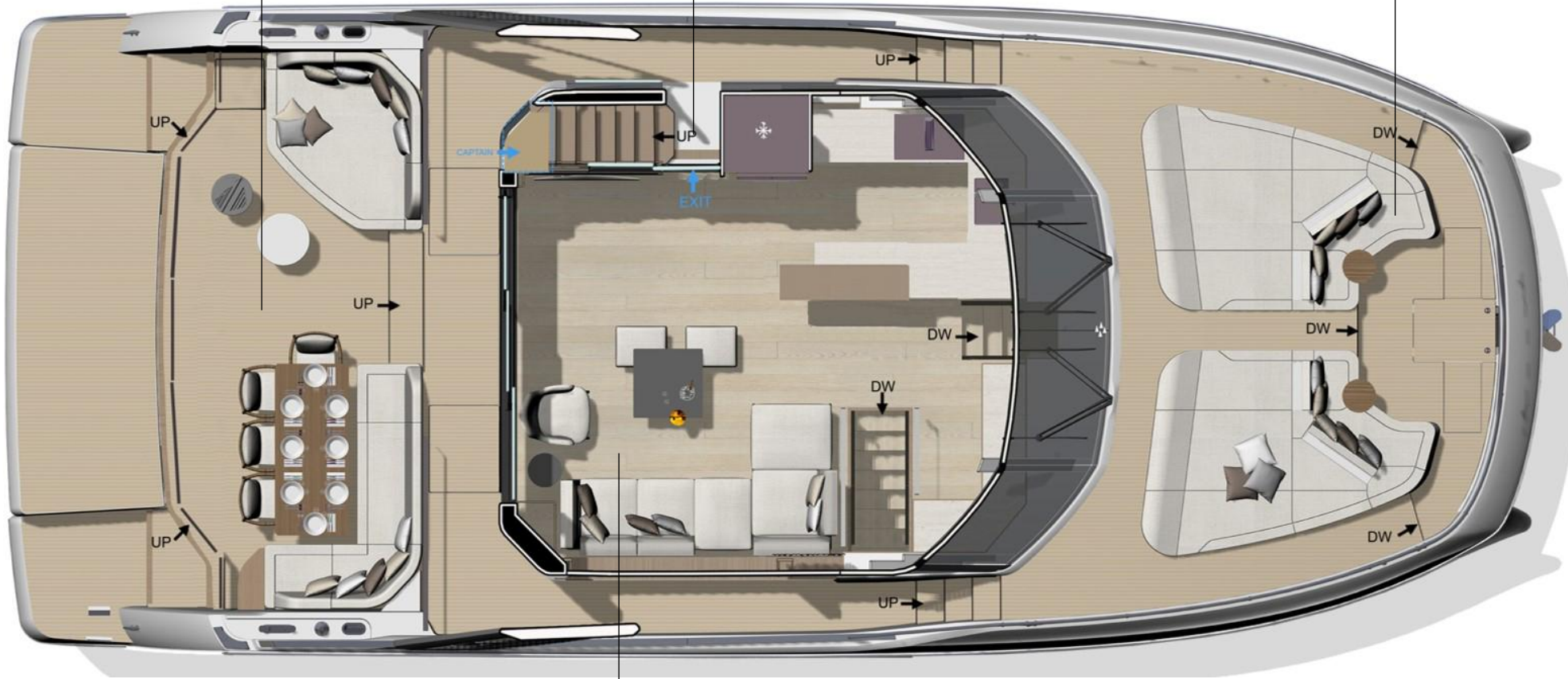

Bright and welcoming living-room

112 m² (1206ft²) living space

* PRELIMINARY DATA, NOT DEFINITIVE.

M7 MAIN DECK – CENTRAL LIVING COCKPIT

Pool Terrace central U shape living



112 m² (1206ft²) living space

* PRELIMINARY DATA, NOT DEFINITIVE.

Pool Terrace central U shape living + dining table

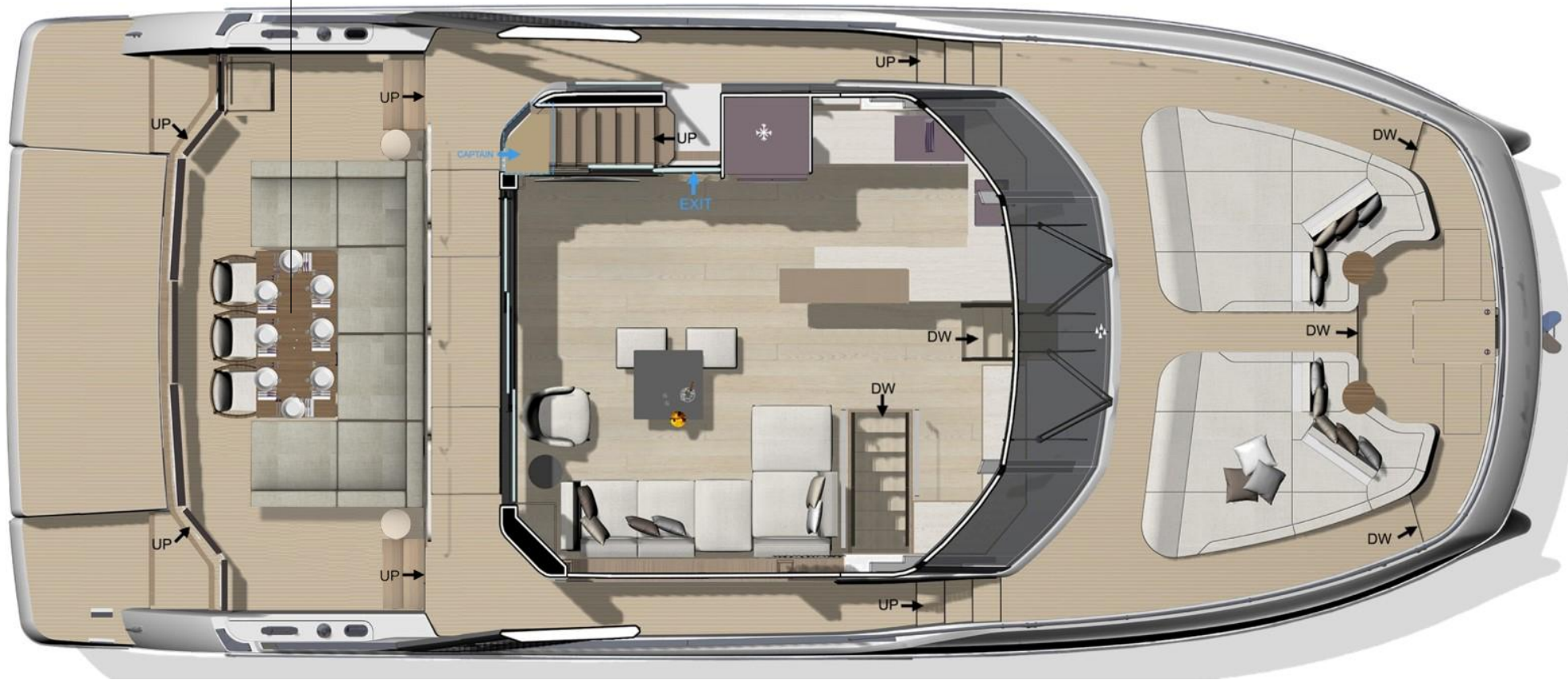

112 m² (1206ft²) living space

* PRELIMINARY DATA, NOT DEFINITIVE.

M7

SUCCUMB TO THE WARMTH AND COMFORT



- Full beam Master Suite
- Open sea view with large hull windows
- Central king-size bed

* PRELIMINARY DATA, NOT DEFINITIVE.

M7

SUCCUMB TO THE WARMTH AND COMFORT



- Fully flush suite from desk to bathroom
- Two generous wardrobes for Madame and Monsieur
- Concealed sliding door for privacy closure of the bathroom area

* PRELIMINARY DATA, NOT DEFINITIVE.

M7

SUCCUMB TO THE WARMTH AND COMFORT



- ❖ Contemporary design
- ❖ Separate shower and separate toilet
- ❖ Double basin with large mirror

* PRELIMINARY DATA, NOT DEFINITIVE.



- Central king-size bed facing the sea
- Plenty of natural light thanks to large hull window
- En-suite private bathroom

* PRELIMINARY DATA, NOT DEFINITIVE.

M7 LOWER DECK

Option: 3rd crew member accommodation

Crew area X2 beds

VIP stateroom: 10 m²/ 108ft²

Master suite: 20m²/215ft²

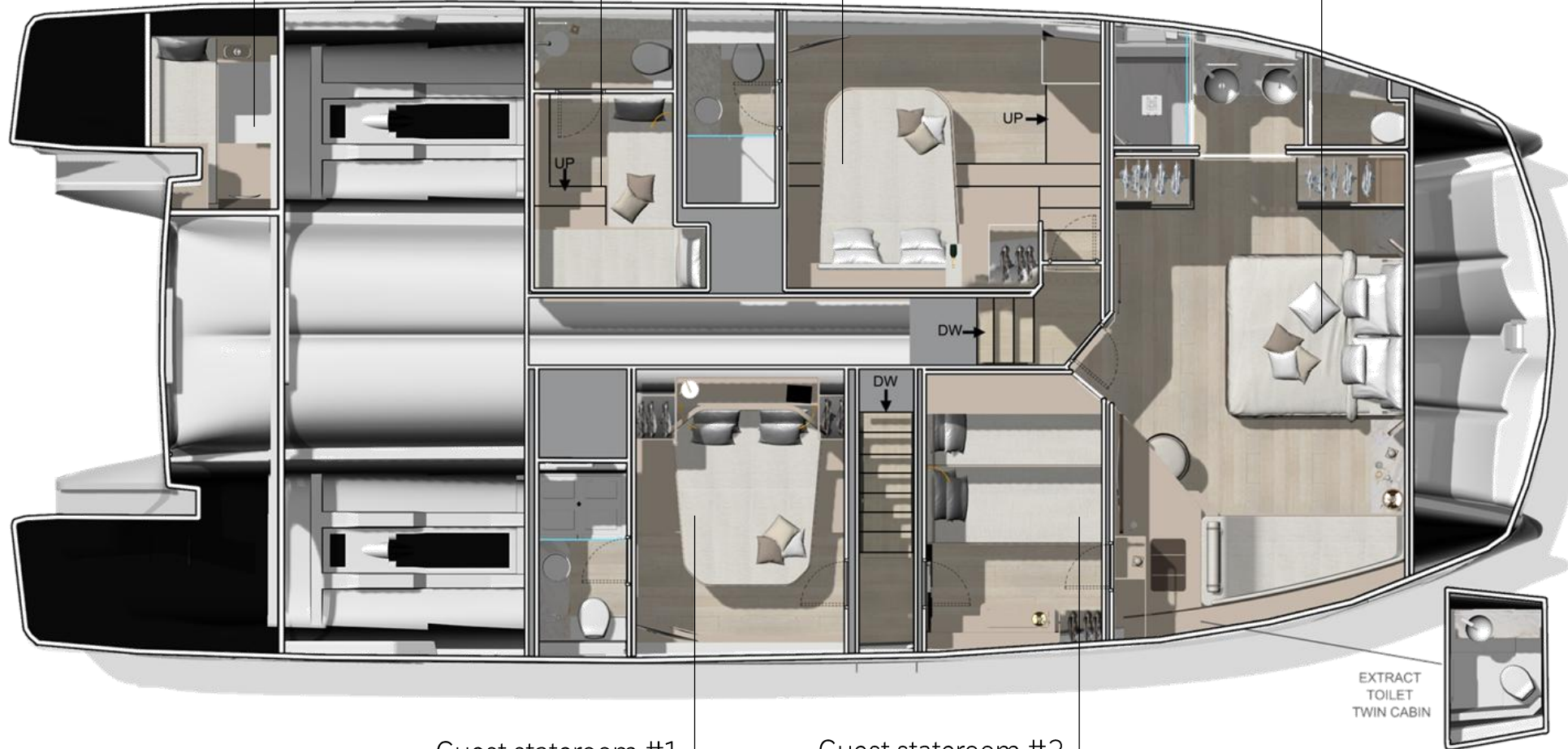

Guest stateroom #1
8 m²/86ft²

Guest stateroom #2
6 m²/65ft²

EXTRACT
TOILET
TWIN CABIN





53 m² (570ft²) living space

* PRELIMINARY DATA, NOT DEFINITIVE.

M7

SEVERAL STORAGE AREAS

STD STORAGE LAYOUT:

-  STANDARD Storage in same volume of additional OPT Crew Cabin Crew Cabin Port after side. Approximate Volume 4m³
-  STANDARD Storage PORT side sofa for seabobs, ropes, safety equipments, and so on. Approximate Volume 1m³
-  STANDARD Storage in STARBOARD Sofa for small equipments and accessories. Approximate Volume 0,8 m³
-  STANDARD Storage in Central nacelle for inflated SUP, Canpoy poles (OPT) and "long" equipment. Approximate Volume 1,7 m³



* PRELIMINARY DATA, NOT DEFINITIVE.

M7

SEVERAL STORAGE AREAS

STANDARD STORAGE LAYOUT:

 STANDARD Storage STARBOARD After Sofa.
Approximate Volume 0,6 m³

 STANDARD Storage STARBOARD Forward Sofa.
Approximate Volume 0,5 m³

 STANDARD Storage in PORT side Sofa.
Approximate Volume 1 m³



* PRELIMINARY DATA, NOT DEFINITIVE.

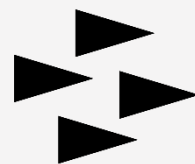

www.prestige-yachts.com

SPBI - S.A. au capital de 51.541.628 € - Siège social: Parc d'activités de l'Eraudière - 34 rue Eric Tabarly - 85170 Dompierre-sur-Yon
RCS 491 372 702 - La Roche-sur-Yon